

Silhouette Cutting Machine
Supplies Manual

Support Roller

MANUAL NO. SPT-ROLLER-UM-151

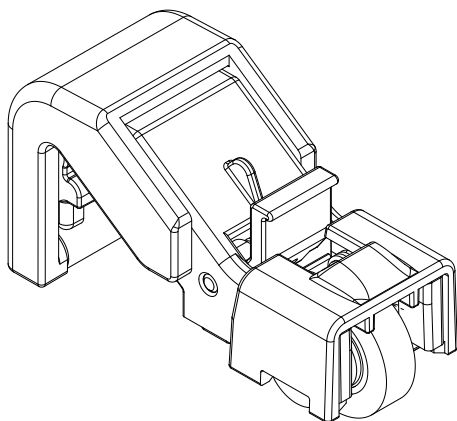

To ensure safe to use

Note

- Please read this manual carefully in advance to use the product safely and correctly.
- The precautions listed in this manual are important for your safety. Always observe these precautions.

Precautions for Use

- When attaching the support roller, please refrain from applying excessive force to the lever, as this may result in damage.
- Exercise caution to avoid pinching your fingers when operating the lever.
- To prevent the accumulation of debris such as cut waste in the support roller, perform regular cleaning. The presence of foreign objects may lead to misalignment during operation.
- Ensure that the support roller is mounted at the designated grid position.
- The contents of the supplies manual are subject to change without notice.

About Support Roller

The following optional sets (sold separately) are available for purchase to use with the Support Roller.

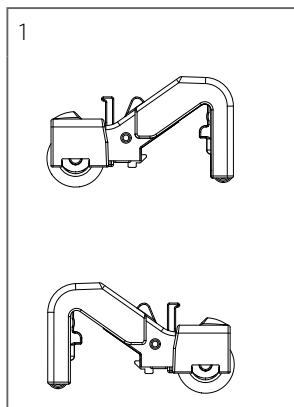

	Product Name	Model Number	Contents
1	Support Rollers Set - White	SPT-ROLLER-SET-WHT	2 Pieces
	Support Rollers Set - Matte Black	SPT-ROLLER-SET-BLK	2 Pieces
	Support Rollers Set - Matte Pink	SPT-ROLLER-SET-PNK	2 Pieces

Overview

This product is a support roller designed to prevent media lifting during operation. The position and quantity of rollers can be adjusted according to the size of the media. It helps prevent misalignment, which commonly occurs during long-length cuts or when cutting roll media.

Supported model

CAMEO5 Series(CAMEO5, CAMEO5 PLUS, CAMEO5α, CAMEO5α PLUS), CAMEO PRO MK-II

How to Attach the Support Roller

To prevent media lifting, attach the support roller at locations where lifting is likely to occur.

- 1** Set the lever to the forward (unlocked) position.
- 2** Align the claw of the support roller (see illustration below) with the groove on the main unit's rail and hook it securely.
- 3** Set the lever to the forward (unlocked) position. Push the support roller firmly along the rail shape until it fits snugly.

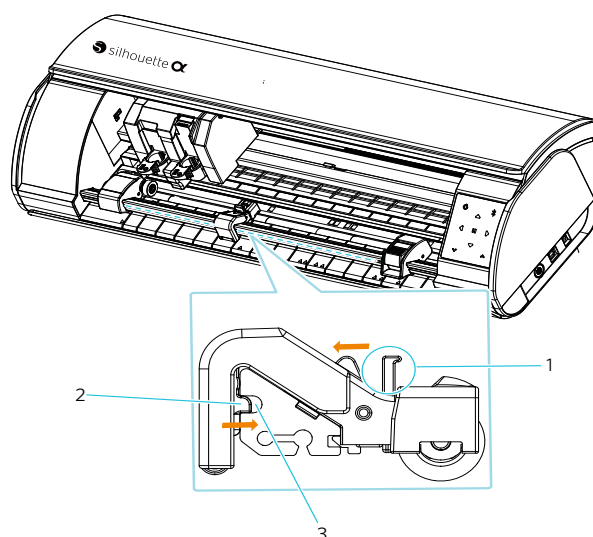

1. Pull the lever forward
2. Support roller claw
3. Rail groove on the main unit

Note

Ensure that the support roller is mounted at the designated grid position.

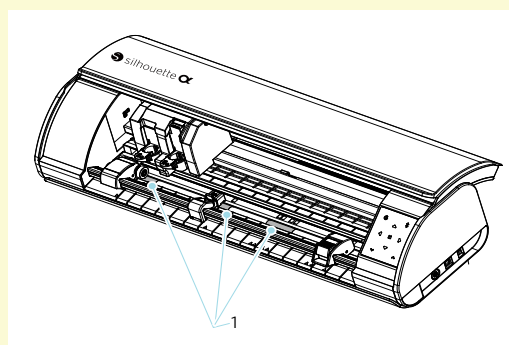

1. Grid

How to remove the Support Roller

Pull the lever toward you to release the lock, then carefully detach the roller from the main unit.

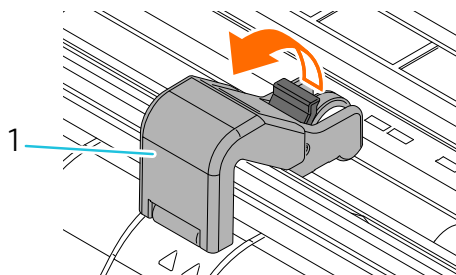

1. Optional item and can be removed

For CAMEO5 Series

The CAMEO5 series comes equipped with two built-in support rollers. These rollers are pre-installed on the main unit and cannot be removed.

If you want to secure media using more than two support rollers—depending on the media size—you may install additional support rollers as optional items.

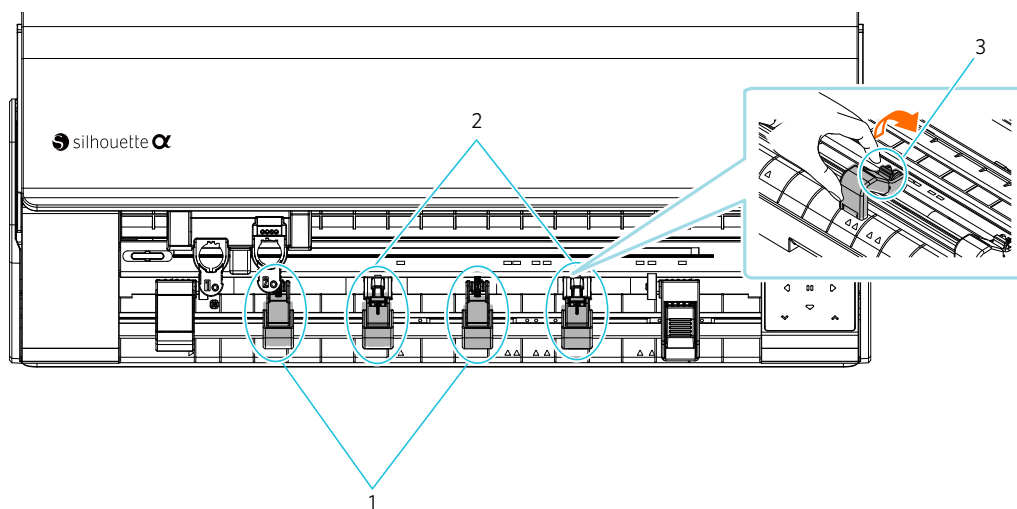

1. Standard Accessory (Fixed in place)
2. Optional item (removable)
3. Optional item lever

For CAMEO PRO MK-II

The CAMEO PRO MK-II comes standard with five support rollers pre-installed on the main unit. All of these rollers are removable.

When using long-length media or when additional media stabilization is required, optional support rollers can be installed to supplement the standard rollers.

It is also possible to replace all standard support rollers with optional ones, depending on your specific application or preference.

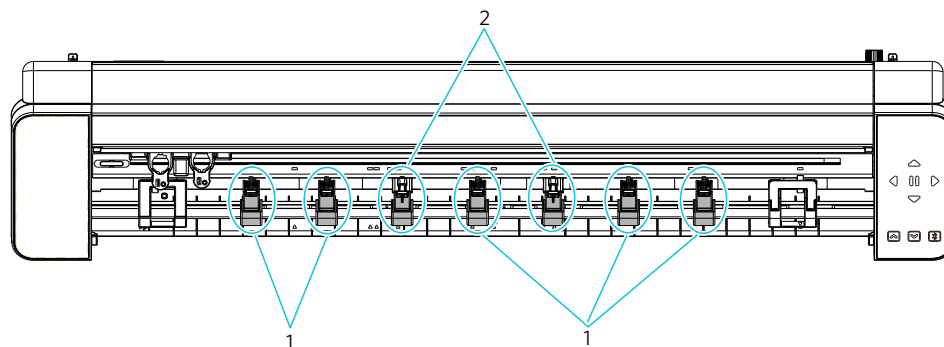

1. Standard Accessory (removable)
2. Optional Item (removable)

